

The Overview

Property Name:
Catalina
4 Cei Dafydd
Barry
CF63 4BH

Price:
£130,000

Qualifier:
Asking price

**1**

**1**

**1**

**C**

The EPC

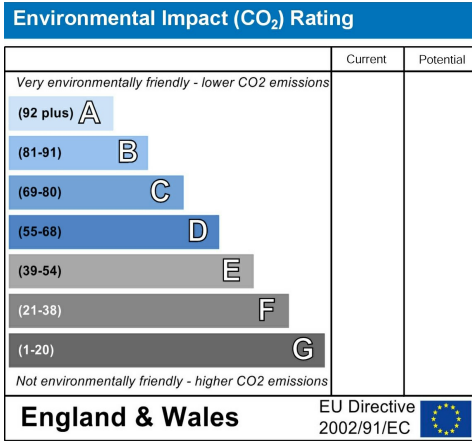
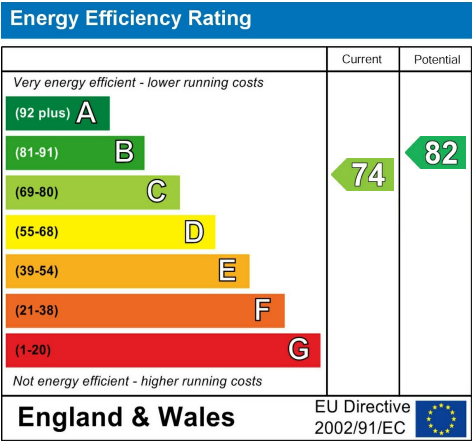

The Bullet Points

- One-bedroom ground-floor apartment at the scenic Barry Waterfront location
- Immaculate white and grey finish throughout, creating a modern ambience
- Open-plan living room and kitchen, offering a spacious and inviting atmosphere
- Stylish kitchen with modern white finish and integrated appliances for added convenience
- Allocated parking space, ensuring easy access and comfort for residents
- Secure access with a fob entry system and a communal entrance hall
- Family bathroom with elegant grey tiling featuring a bath and shower
- French doors lead to a charming grass patch garden, perfect for outdoor enjoyment
- Spacious main bedroom with beautiful mirror wardrobes for ample storage
- No onward chain, making it ready to move in hassle-free



Catalina, 4 Cei Dafydd, Barry, CF63 4BH

The Main Text

*** No Onward Chain ***

Welcome to Catalina, Cei Dafydd Barry, CF63 - a delightful one-bedroom ground-floor apartment on the picturesque Barry Waterfront. This charming property offers a convenient living space and the luxury of allocated parking space for your vehicle. Safety and security are paramount, as the property features a fob entry system providing exclusive access to the communal entrance hall.

Provides an attractive package of contemporary design, practicality, and a coveted waterside location. Take advantage of the opportunity to make this delightful property your new home sweet home. Book your viewing today!

Ground Floor

Step inside this immaculately presented apartment, where you will find a beautiful white and grey finish, creating a modern and stylish ambience. The absence of any onward chain ensures a smooth and hassle-free transition, allowing you to move in and start enjoying your new home without delay.

Upon entering, you are greeted by a welcoming entrance hall with a practical storage cupboard, perfect for storing your belongings. The family bathroom boasts elegant grey tiling and features a bathtub with a shower, offering a relaxing space to unwind after a long day.

The heart of the home lies in the open-plan living room and kitchen area. This seamless integration creates a spacious and inviting atmosphere, ideal for both relaxation and entertaining. The kitchen is a true culinary haven with its modern white finish, complemented by sleek black handles. Additionally, the kitchen boasts integrated appliances, providing the utmost convenience for your daily cooking needs.

Adding to the allure of this fantastic property, the living room offers a breath of fresh air with French doors that lead outside to a charming grass patch garden. This outdoor space is perfect for enjoying the sunshine, hosting gatherings, or enjoying tranquil moments in the open air.

Retreat to the main bedroom, which impresses with its generous proportions, ensuring plenty of room for all your furnishings and comfort. The room is enhanced by beautiful mirror wardrobes, offering ample storage and creating a sense of depth and light.

Additional Information

Tenure: Leasehold
EPC Rating: 74 (C)
Council tax band: C
Borough: Vale of Glamorgan

Lease Information

Lease term 999 Years
Term remaining 981 Years left
Ground rent £96 PA
Service Charge £1600 PA
Management fees Review 2024
Management Company Seal and Co

Local Schools

The area is fortunate to boast a selection of excellent local schools catering to the educational needs of families living in the community. Within proximity, parents will find a variety of primary and secondary schools known for their academic achievements and nurturing environments. These schools prioritize the development of well-rounded students, emphasizing academic excellence, extracurricular activities, and character building. With dedicated and experienced teaching staff, modern facilities, and a commitment to student success, families can rest assured that their children will receive a high-quality education near this desirable property.

Transport Links

Offers excellent transport options for residents, making it a convenient and accessible place to live. The area benefits from well-connected road networks, allowing easy access to major routes and nearby towns. Additionally, public transportation is readily available, with bus stops conveniently situated, providing efficient travel within the locality and connecting to neighbouring areas. For those who prefer rail travel, the property will likely be within a reasonable distance from train stations, granting access to wider regions and even major cities. Overall, the local transport infrastructure ensures that residents of Catalina can effortlessly navigate their way around, whether for work, leisure, or visiting nearby amenities.

The Local Area

The local area in Barry, The Waterfront, is a charming and vibrant community with much to offer its residents. Set along the picturesque Barry Waterfront, it presents a beautiful and tranquil setting for those seeking a serene lifestyle by the water. Residents can enjoy leisurely walks along the waterfront, enjoying scenic views and relishing the refreshing sea breeze. The vicinity also offers an array of amenities, including shops, restaurants, and cafes, creating a lively and convenient environment for everyday needs. Additionally, the area benefits from excellent transport links, enabling easy access to neighbouring towns and cities, making it a desirable location for commuters and families seeking a well-rounded and enriching lifestyle.

Get pre-approved for a mortgage

A pre-approval letter from a lender will give you a better idea of how much you can afford to spend on a property. This will also give you an advantage when making an offer on a property, as the seller will know you have already been approved for a mortgage.

Local Estate Agent - Conrad Binding

RE/MAX Estate Agents Barry is a local estate agency in Barry, Wales. As a self-employed estate agent, the business operates with over a decade of experience in the industry.

RE/MAX Estate Agents Barry specializes in helping clients buy and sell properties in the local area. They offer a range of services to clients, including property valuations, property listings, property management, and negotiating offers.

One unique aspect of RE/MAX Estate Agents Barry is their love for dogs. They understand the importance of pets in the home buying and selling process and welcome furry friends into their office.

Overall, RE/MAX Estate Agents Barry is a reliable and experienced estate agency business that focuses on providing quality service to its clients in the Barry area.

If you are interested in getting any advice, please get in touch with the local agent - Conrad Binding.



RE/MAX
PROPERTY HUB

Catalina, 4 Cei Dafydd, Barry, CF63 4BH

The Photographs

Please note: we have provided space for 48 photographs over the next four pages, but we may not fill all 48 spaces if we don't need to. If there are more than 48 photographs then we will email the remainder to you.



RE/MAX
PROPERTY HUB

Catalina, 4 Cei Dafydd, Barry, CF63 4BH

The Photographs

Please note: we have provided space for 48 photographs over the next four pages, but we may not fill all 48 spaces if we don't need to. If there are more than 48 photographs then we will email the remainder to you.

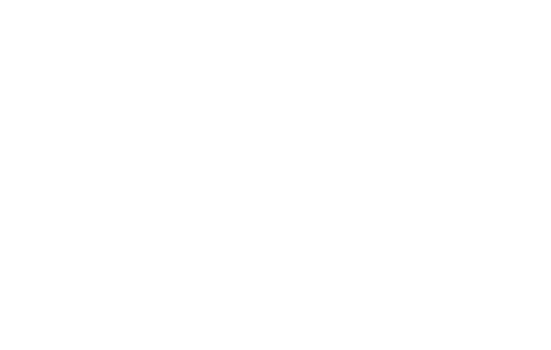
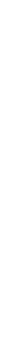

Catalina, 4 Cei Dafydd, Barry, CF63 4BH

The Floorplan

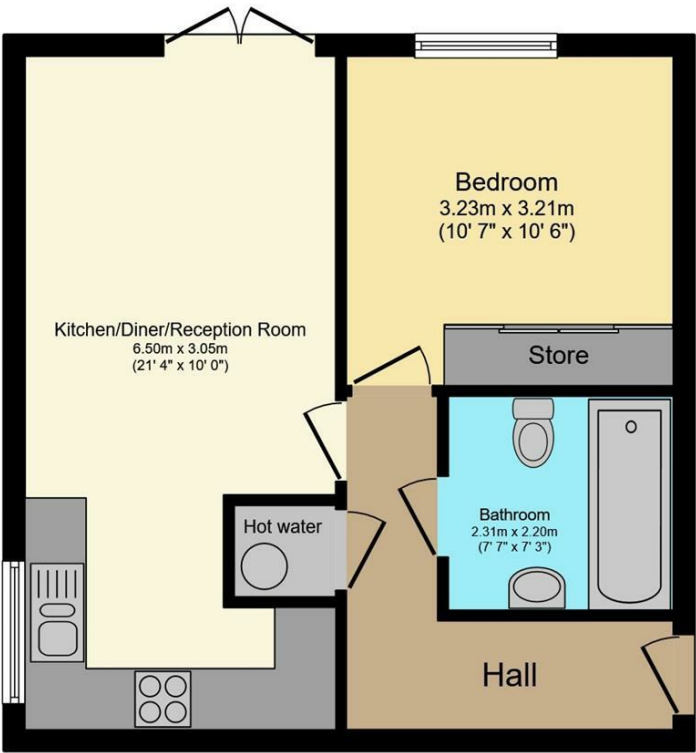

Floor Plan

Total floor area 42.0 sq.m. (452 sq.ft.) approx
This plan is for illustration purposes only and may not be representative of the property. Plan not to scale. Powered by PropertyBox

The Map

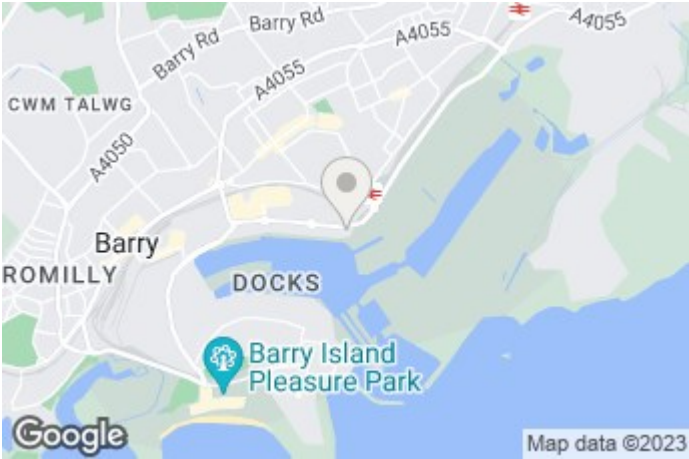

Catalina, 4 Cei Dafydd, Barry, CF63 4BH